

MODULAR AND SCALABLE

# DC SERIES

DATA CENTER CABINETS

**NUCOR**<sup>®</sup>  

---

**DATA SYSTEMS**



## MODULAR AND SCALABLE **DC SERIES**

### DATA CENTER CABINETS

Our DC Series is the Data Center Standard for high-capacity, high-weight load rated, feature rich cabinets.

These deployable, Seismic and UL-rated cabinets are fully welded, pre-assembled, and come standard with features such as recessed PDU Cavities, and are configurable with or without doors, sides and tops to provide a truly modular scalable solution.

- 4** Cabinet Features
- 5** Frames
- 5** Mounting Rails
- 6** Doors
- 7** Side Panels
- 7** Cabinet Tops

## DC SERIES

# CABINET FEATURES

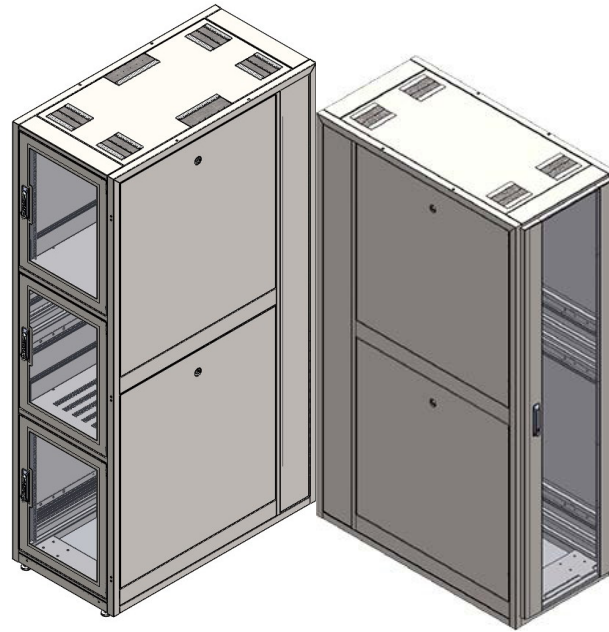

- Available in four widths, four heights and two depths
- All welded steel tubing construction provides a 4000 lb static load rating and 3500 lb. rolling/shipping rating for high-density integration
- Seismic Zone 4 rated, ULListed
- PCI Compliant cabinet
- 19" wide rack mount
- 7" wide cavity in back of the cabinet allows space for a PDU without going outside the cabinet
- Mounting rails are cage nut style, punched on EIA 5/8-5/8-1/2" standard spacing and are fully adjustable front to rear. All are provided with M6 Cage Nuts and screws
- Optional flush mounted split (top & bottom) side panels supplied with keylock for optimal security
- Optional doors include flush mount perforated doors, split flush mounted perforated doors, and curved surface mount perforated doors. All doors include standard swing-handle locks and have high-airflow honeycomb perforations.
- Optional combination locks available
- Optional flush mount top choices include perforated with cable access, or solid with brushed cable openings
- Open base for raised floor ventilation option
- HD formed bottom structure includes both seismic tiedown and caster mount features
- Four point leveling
- Includes top mount frame coupler
- Optional deployable duty casters available and are rated for 4,000 lbs.
- Standard Black or Hammertone White Powder Coat finish—custom colors upon request



# DC SERIES COMPONENTS

## FRAMES

- Available in 4 heights, 3 widths and 3 depths
- All welded steel tubing construction provides a 4000-lb. static load rating and 3500-lb. rolling/ shipping rating for high-density integration
- 7" W/PDU cavity in rear
- Includes (2) pair of Cage Nut mounting rails and leveling feet
- Includes top mount frame coupler
- HD formed bottom structure includes both seismic tie down and caster mount features
- Frames are Seismic Zone 4 rated, UL Listed
- Standard Black or Hammertone White Powder Coat finish— custom colors upon request

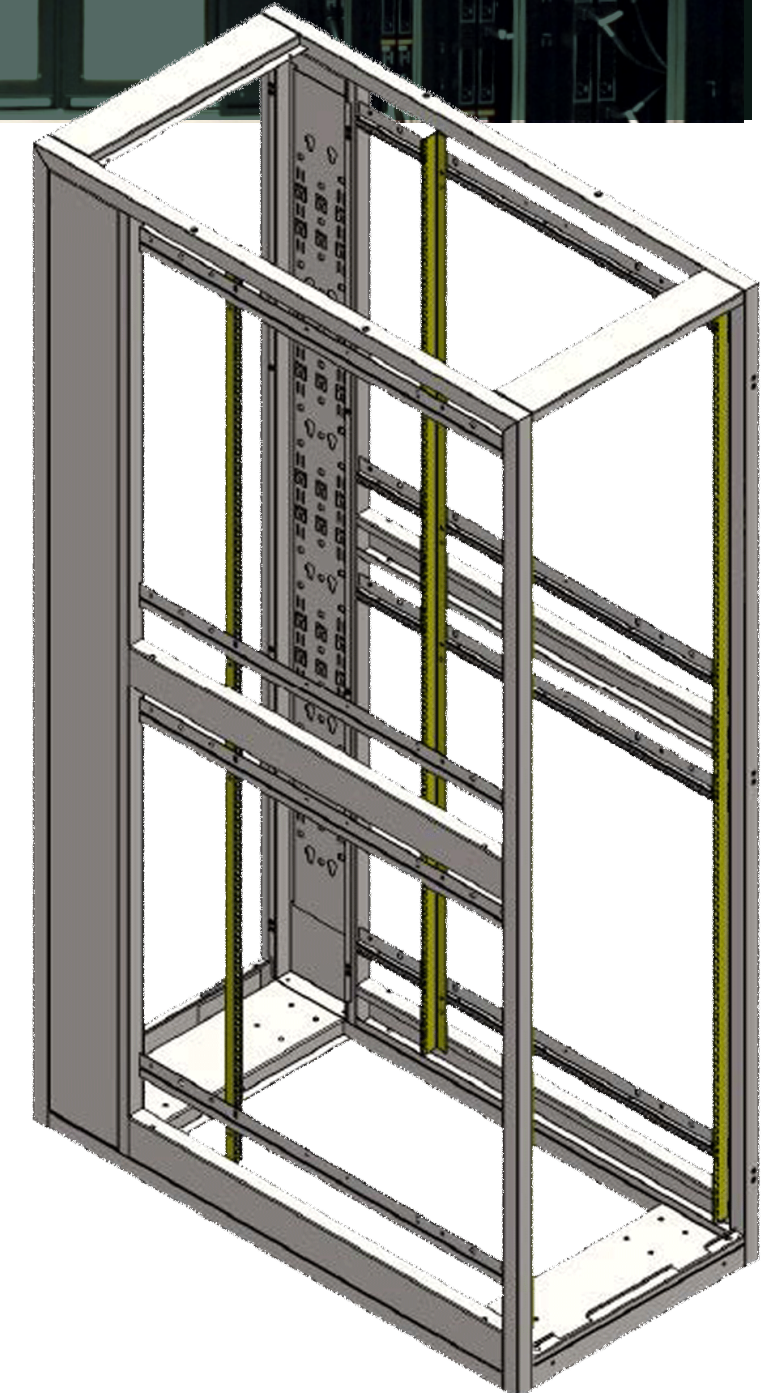

## MOUNTING RAILS

- 12-gauge steel Cage Nut style punched on EIA standard spacing
- RU marks and silk-screened number

## DC SERIES

### PRE-CONFIGURED PART NUMBER MATRIX

**DC - 48 24 48 1 P 1 - 1**

PRODUCT HEIGHT IN RU FRAME WIDTH (inches) FRAME DEPTH (inches) SIDES TOP DOORS COLORS

HEIGHT IN RU	FRAME WIDTH (inches)	FRAME DEPTH (inches)	SIDES	TOP	DOORS	COLORS
42	24	42	0=No Sides	N=No Top	0=No Doors	1=Black
45	28	48	1=One Side	P=Perf Top w/ Cable Entrance	1=Front Flush Perf/Rear Flush Split Perf	2=White
48	29.5		2=Two Sides	S=Solid Top w/ Brushed Cable Entrance	2=Curved Front Perf/Rear Flush Split Perf	
52	30				3=Curved Front Perf/Rear Curved Perf	
	31.5				4=Front Flush Perf/Rear Flush Perf	

## DC SERIES DOORS

- Carbon steel all welded construction for strength
- Curved perforated front doors (79% open)
- Flush mount perforated rear door is field reversible without tools
- Split perforated rear doors also available
- Doors include standard swing-handle lock
- Optional Electronic Locks, Proximity Locks and Combo Locks available
- Standard Black or Hammertone White Powder Coat finish—custom colors upon request

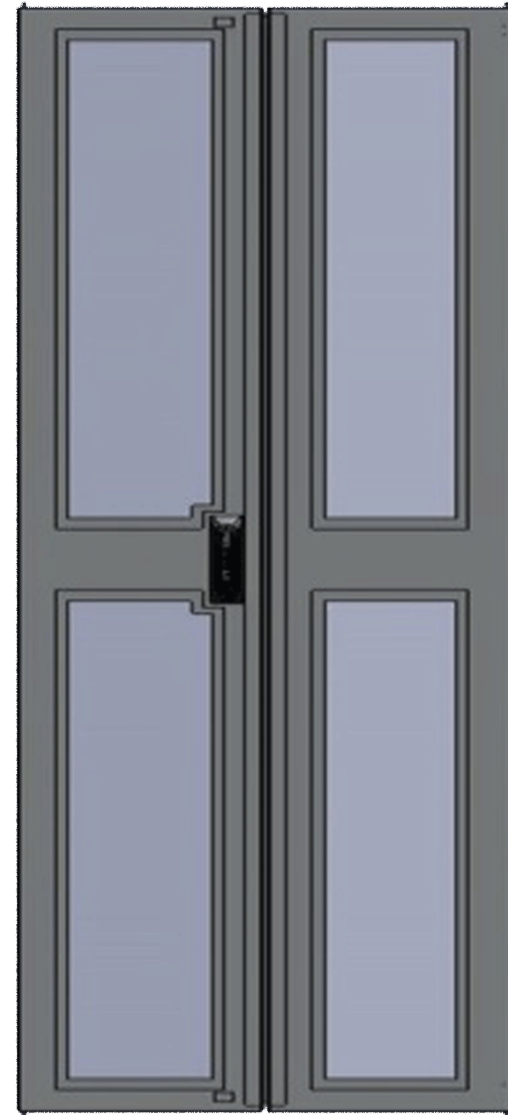
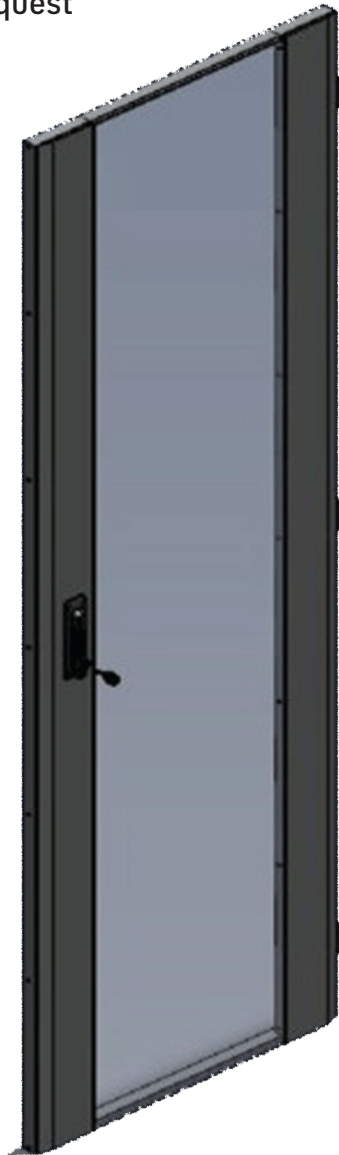

### LOCK OPTIONS

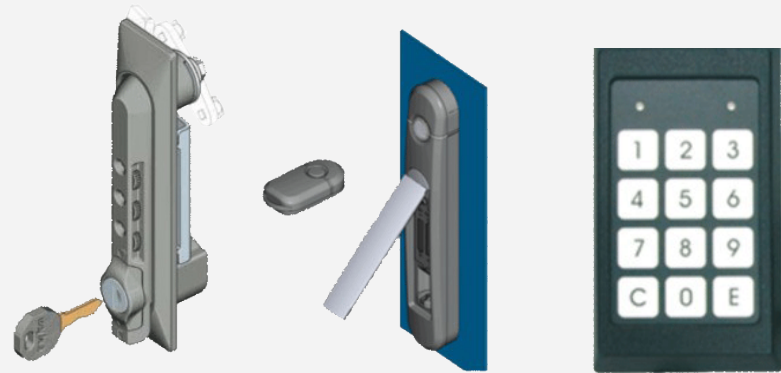

## DC SERIES SIDE PANELS

- Flush mount split side (top/bottom) solid side panels equipped with key
- Lock for optimal security
- Constructed from carbon steel
- Standard Black or Hammertone White Powder Coat finish—custom colors upon request

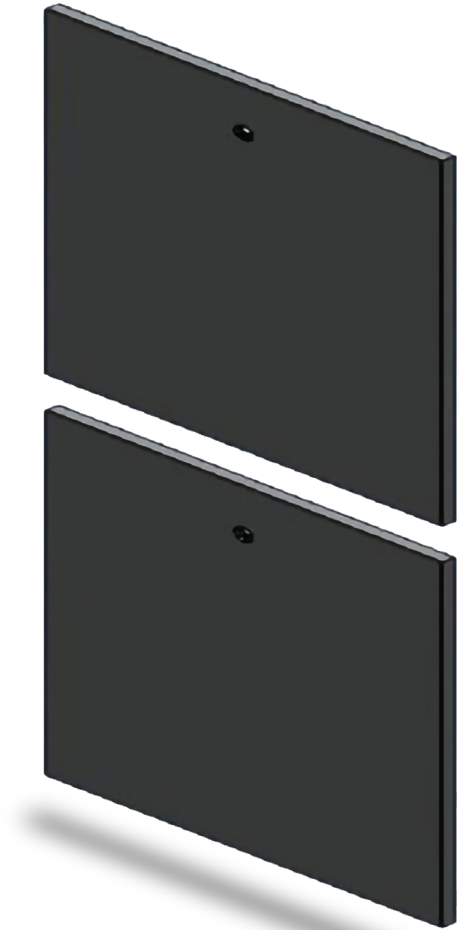

## CABINET TOPS

- Flush mount tops available in 2 styles for 24", 28" and 31.5" wide frames:
  - Perforated top with cable access holes
  - Solid top with brushed cable entry holes
- Carbon steel construction
- Standard Black or Hammertone White Powder Coat finish—custom colors upon request

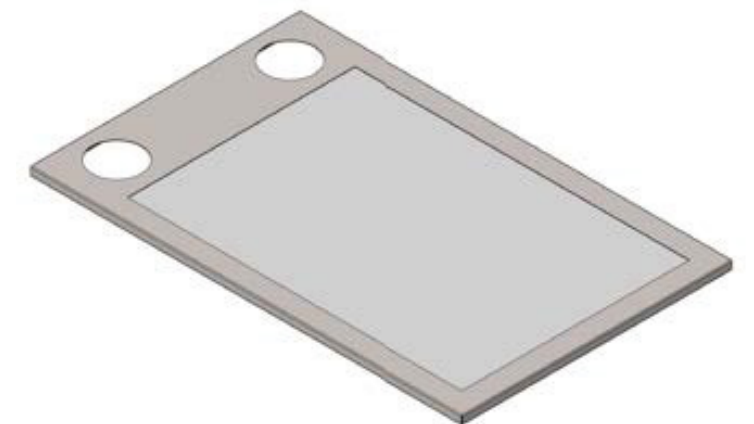



**NUCOR<sup>®</sup>**  
**DATA SYSTEMS**

TEL: 909-796-6200

FAX: 909-796-6223

[sales@nucordatasystems.com](mailto:sales@nucordatasystems.com)

1385 S Tippencanoe Ave., San Bernardino, CA 92408

[NUCORDATASYSTEMS.COM](http://NUCORDATASYSTEMS.COM)